

ZAZA2 DELTA

For games only

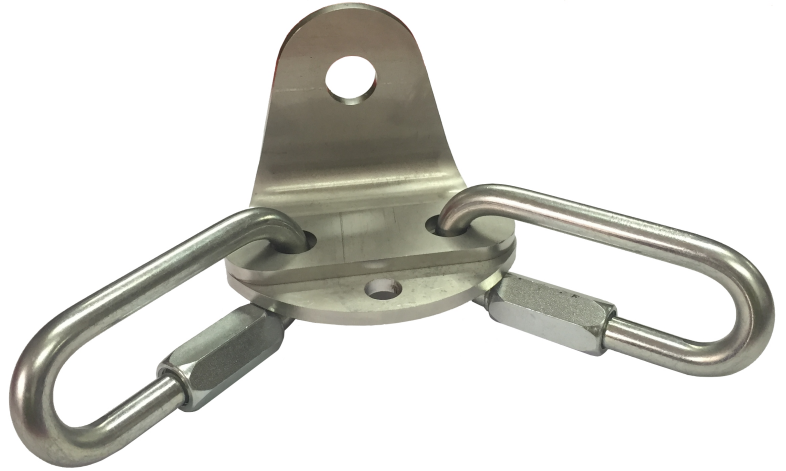
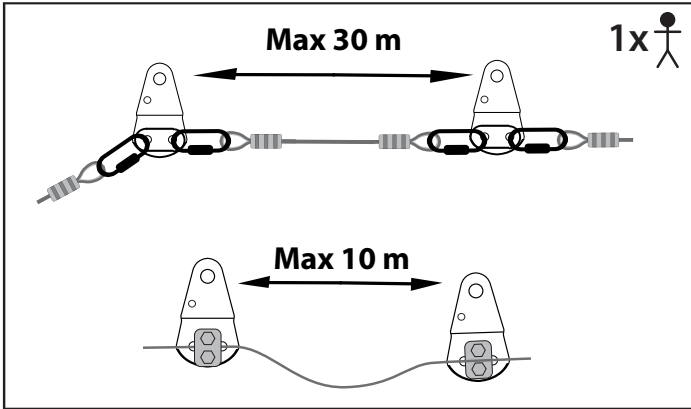

ADVANTAGES:

- SPECIAL FOR ARTIFICIAL STRUCTURE
- REALIZE BENDS OF 0° to 270°
- FLEXIBILITY

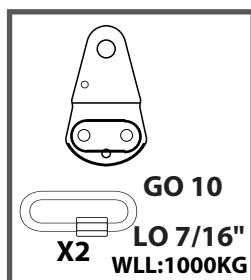
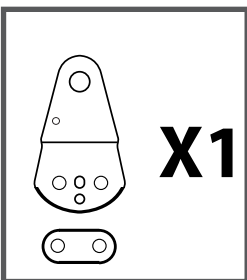
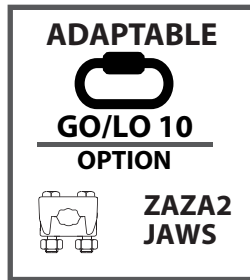

OR

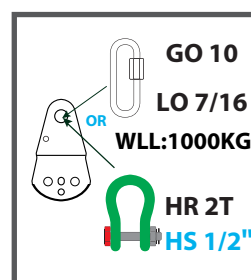
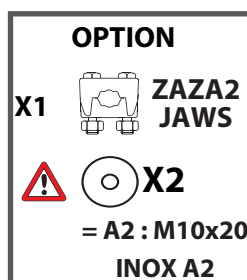

EXAMPLE OF FIXING SYSTEM



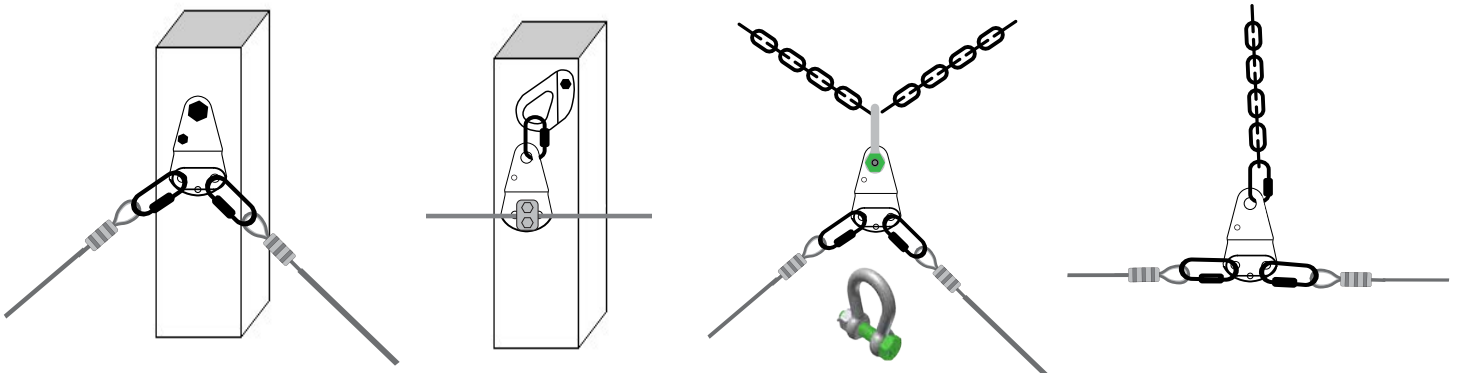

WLL of the fixing element must be correctly sized



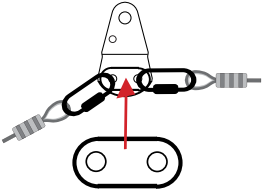

Opération 1

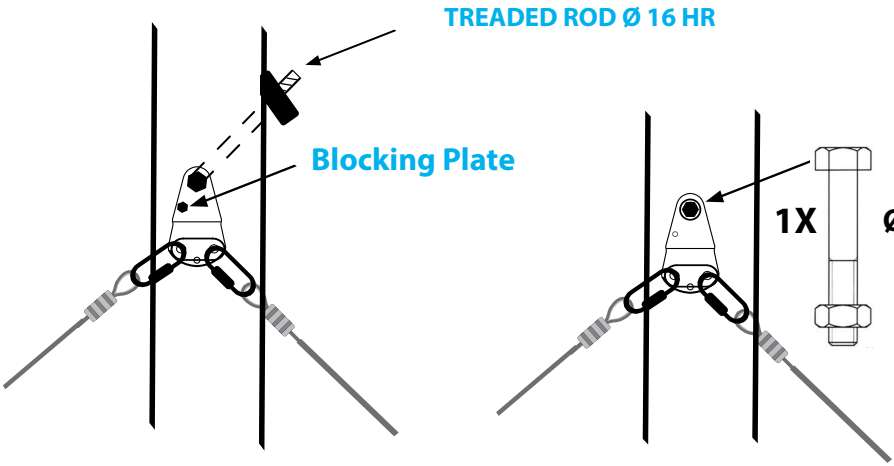
METHOD OF ATTACHMENT

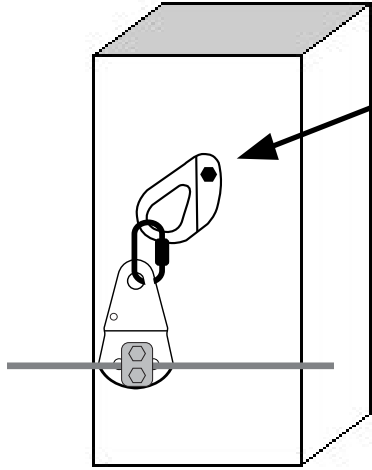

MANDATORY



ANCHOREYES
1X  **Quick link LO 7/16 or 1/2"**
WLL:1000KG

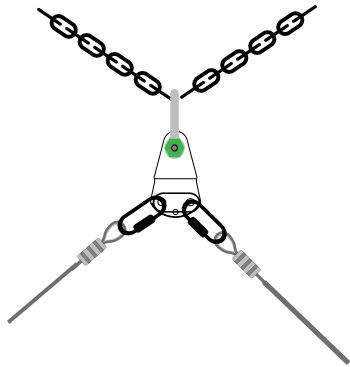

On double chain
 **x 1 HR 2T HS 1/2"**

STANDARDS OF ASSEMBLY



**EN 15567-1
EN 13411-1/7
STANDARDS - ACCT**

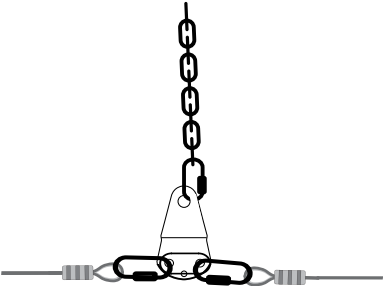

On single chain
1X  **Quick link LO 10 or 7/16 or 1/2" mini**
WLL:1000KG mini

Opération 2

Starting/Arrival Plate

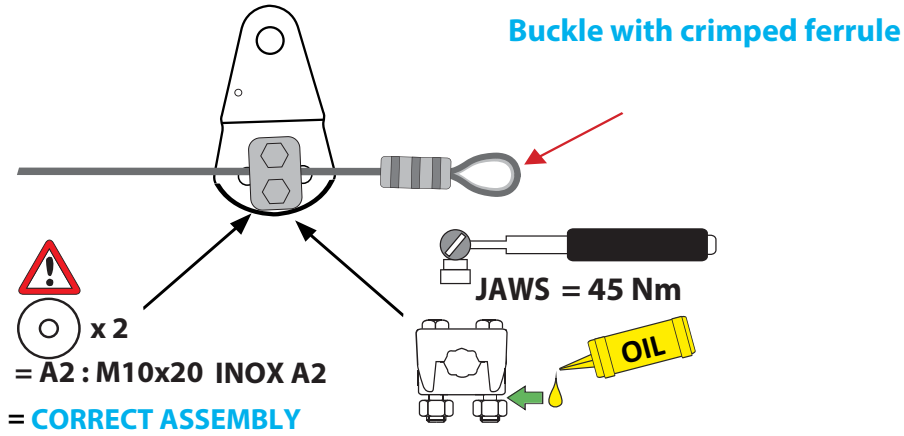

STANDARDS OF ASSEMBLY



EN 15567-1
EN 13411-1/7
STANDARDS - ACCT

Examples of centralized departures

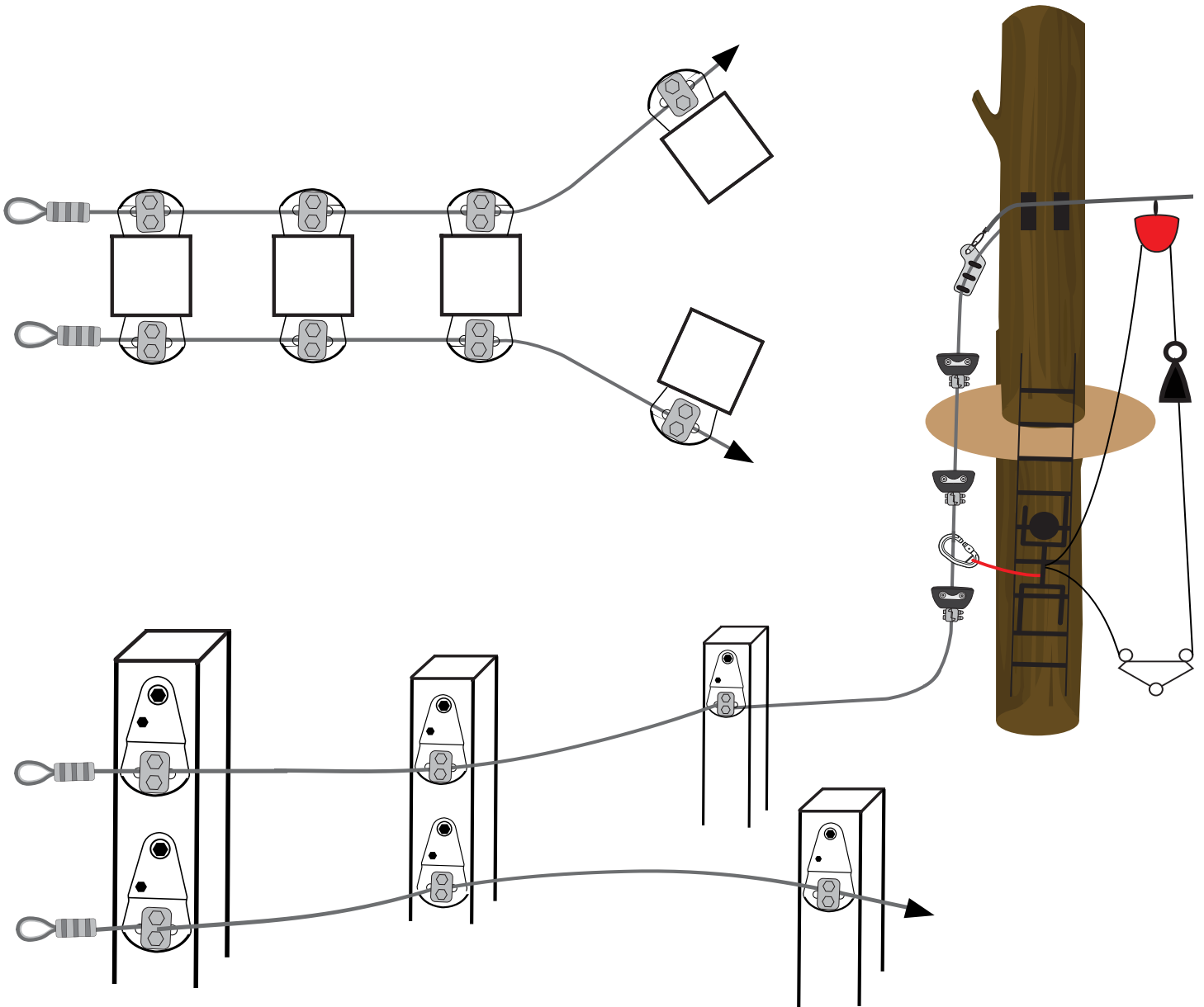

Opération 3

Examples of Combination to Assembly

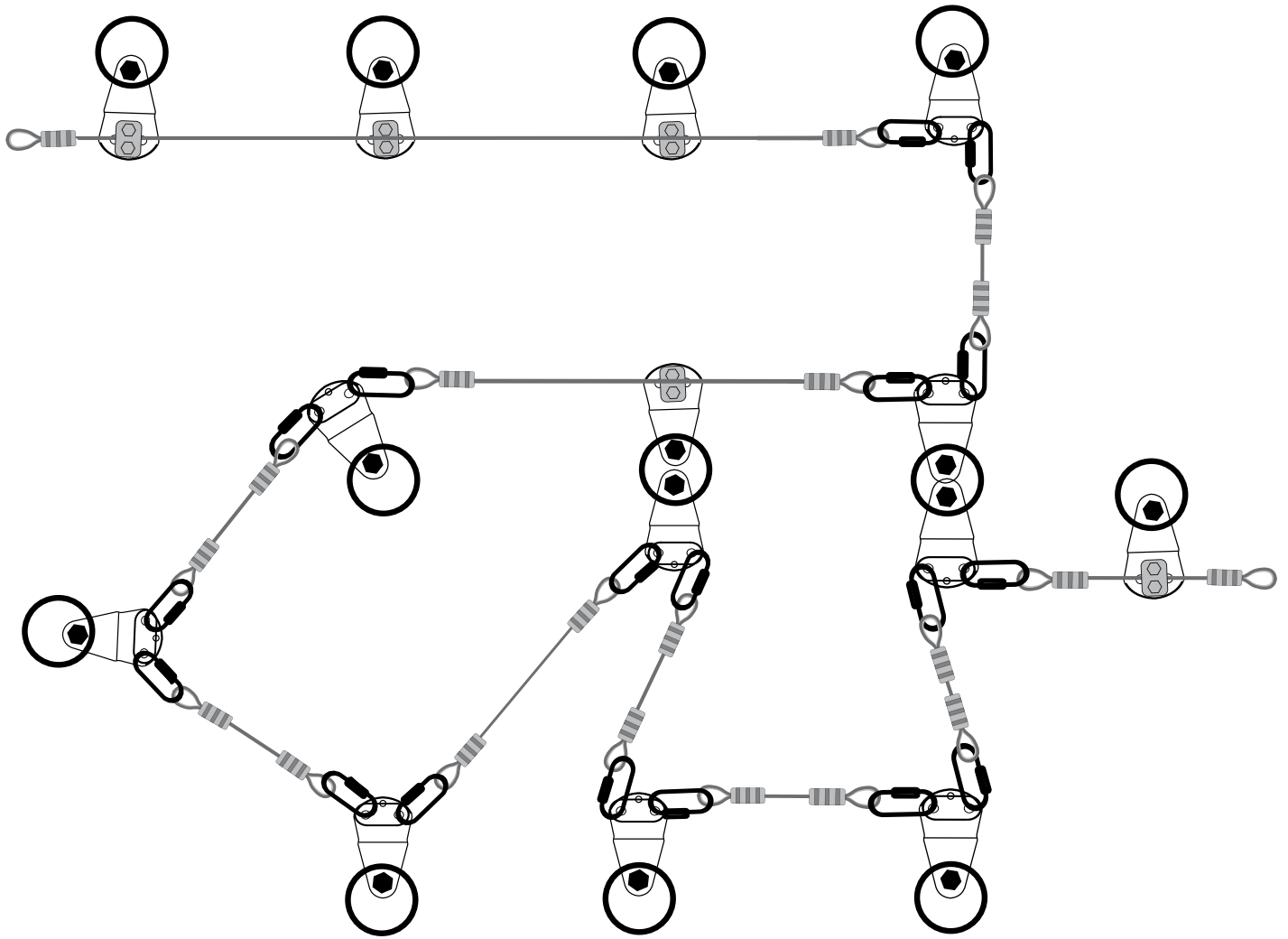

Opération 4

RECOMMENDATION ASSEMBLY

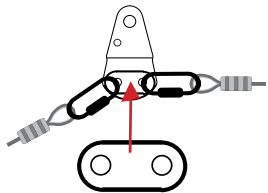

MANDATORY

STANDARDS OF ASSEMBLY



EN 15567-1
EN 13411-1/7
STANDARDS - ACCT

